

1

2

3

4

REVISIONS

REV	DESCRIPTION	DATE	APPROVED
A	INITIAL RELEASE PER ECO 13-17526	122013	L. PITZELE

A

A

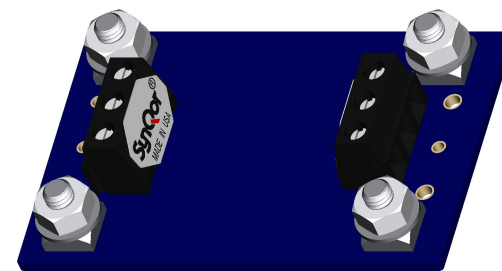
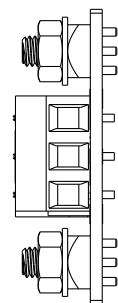
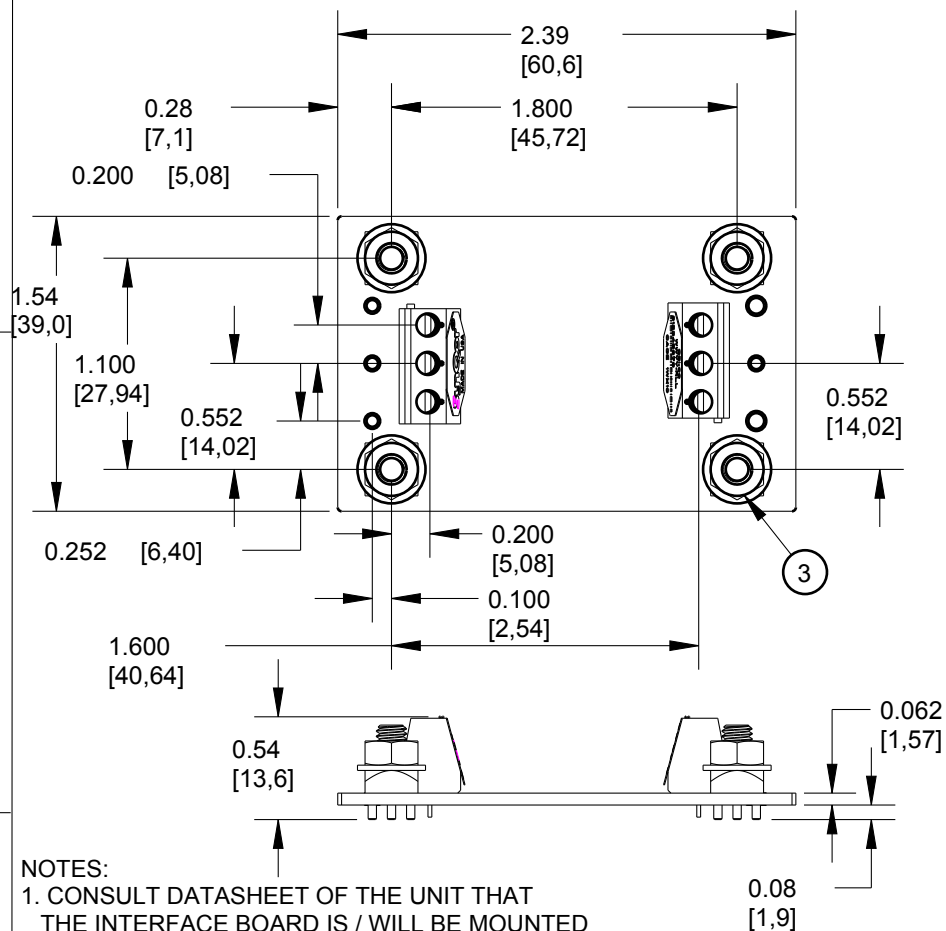

B

B

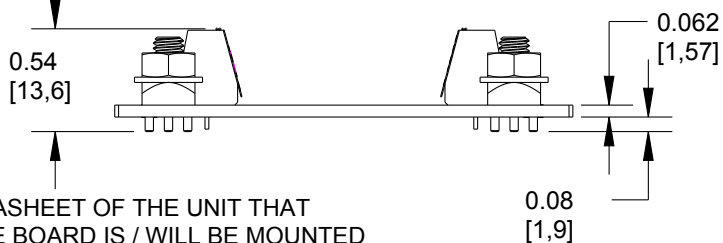

SCALE 0.750

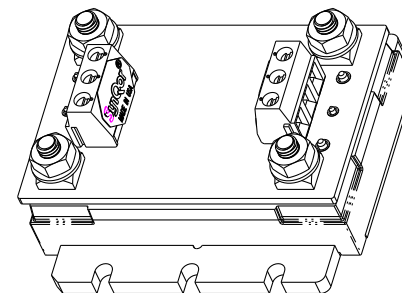
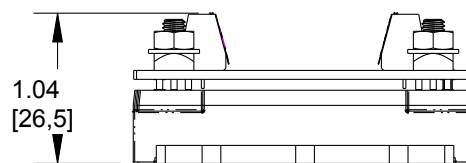

NOTES:

- CONSULT DATASHEET OF THE UNIT THAT THE INTERFACE BOARD IS / WILL BE MOUNTED TO FOR I/O DEFINITIONS, MOUNTING DIMENSIONS AND OPERATING PARAMETERS.
- ALL DIMENSIONS IN INCHES (MM)
TOLERANCES: X.XX ± .02 IN. (X.X ± .5mm)
X.XXX ± .010 IN. (X.XX ± .25mm)
- TERMINALS 1, 3, 4, 8: M4 SCREW POST, MAX TORQUE 6 IN-LB (.7 Nm).
- TERMINAL BLOCKS: WIRE SIZE 16-30 AWG, 13.5A MAX CURRENT PER TERMINAL, MAX TORQUE 4 IN-LB (.5 Nm)
- FITS BOTH NORMAL AND FLANGED QUARTER BRICKS
- ADAPTOR WEIGHT: 1.02 oz (29 g)

C

TOLERANCES:

Unless otherwise specified:
All dimensions in inches
.X +/- .025
.XX +/- .010
.XXX +/- .005
Angles +/- 1°

THIRD ANGLE PROJECTION

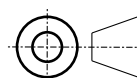

THIS DRAWING IS THE PROPERTY OF SYNQOR INC.
It is not to be reproduced or copied, in whole or in part, or used for furnishing information to others, or for any purpose detrimental to the interests of SynQor. The information shown herein may be protected by patents owned or controlled by SynQor.

SynQor

155 Swanson Road
Boxborough, MA 01719

QBI-02 FILTER INTERFACE ASSY. THROUGH HOLE MOUNTING

SOURCE: PRO/E 020-0000281

SIZE	DATE	DWG. NO.	REV
A	122013	020-0000281	A
SCALE: 1.000	DRAWN: LDP	CHECK:	SHEET 1 of 1

1

2

3

4

C